

WS Enterprises

PROPOSED G + V STORIED RESIDENTIAL BUILDING

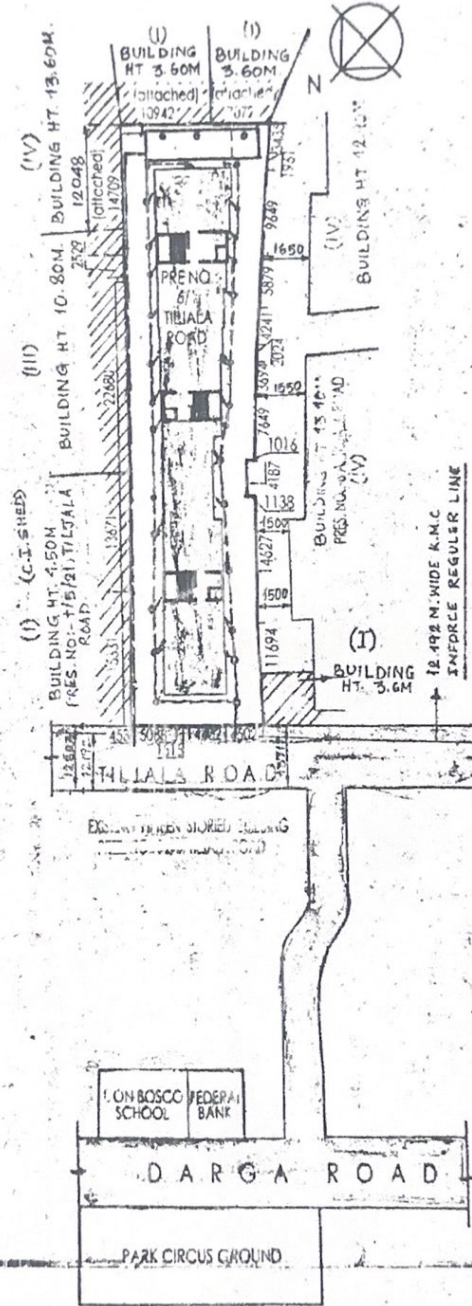

SCHEDULE OF LAND:-

Holding No. 39, Division IV, Sub-Division G, A.D.S.R. Sealdah, P.S. Beniapur, P.O. Circus Avenue District 24 Parganas. (South) situate lying at and being premises no. 6/1, Tiljala Road, Kolkata- 700046, in Ward no. 59

LATITUDE:- 22°32'31.9"N

LONGITUDE:- 88°22'22.9"E

LATITUDE AND LONGITUDE HAS BEEN MEASURED NEAR THE CENTER OF THE LAND.

WS. ENTERPRISES

Partner

SITE PLAN

SCALE - 1:600